

Manual of document scanner

(MAC OS version)

Installation instructions

How to permit the software to run

The software downloaded from our official website through the browser. Then open the software, a security message will pop up saying "unverified developer"(Pic.0-1).

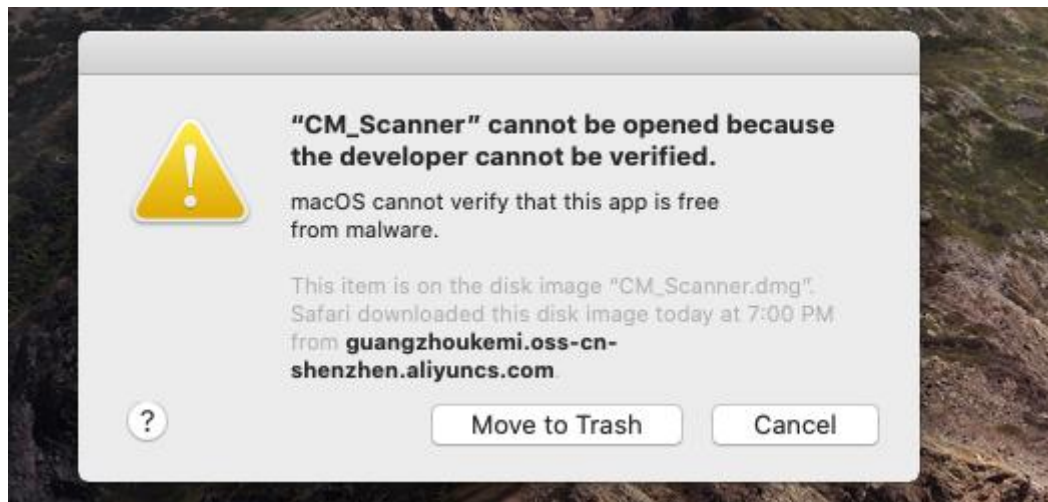

Pic.0-1

In order to make the software work properly, we need to set it in the "System Preferences". Open "System Preferences", then click the "Security & Privacy"(Pic.0-2).

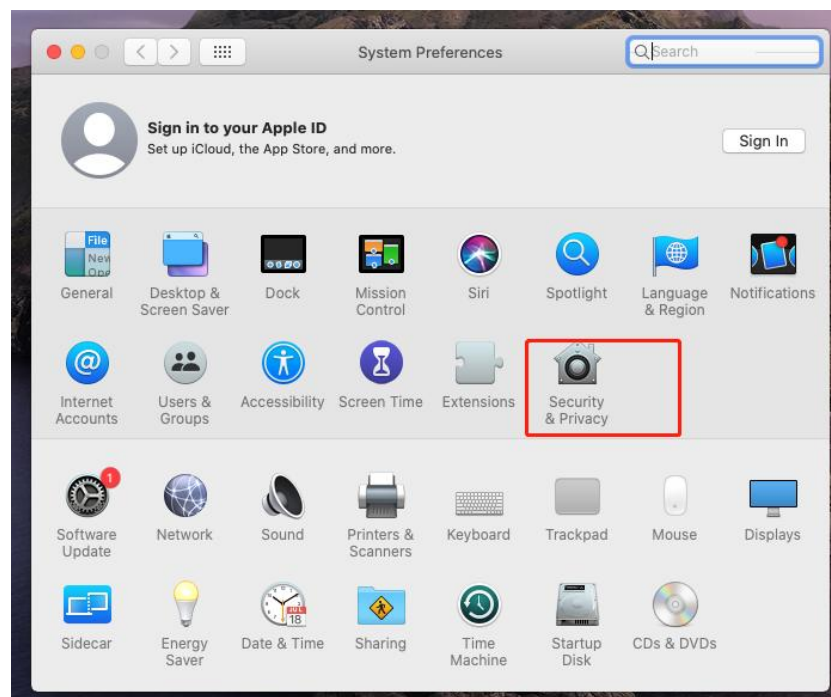

Pic.0-2

Enter the “General” page and click “Open Anyway”(Pic.0-3).

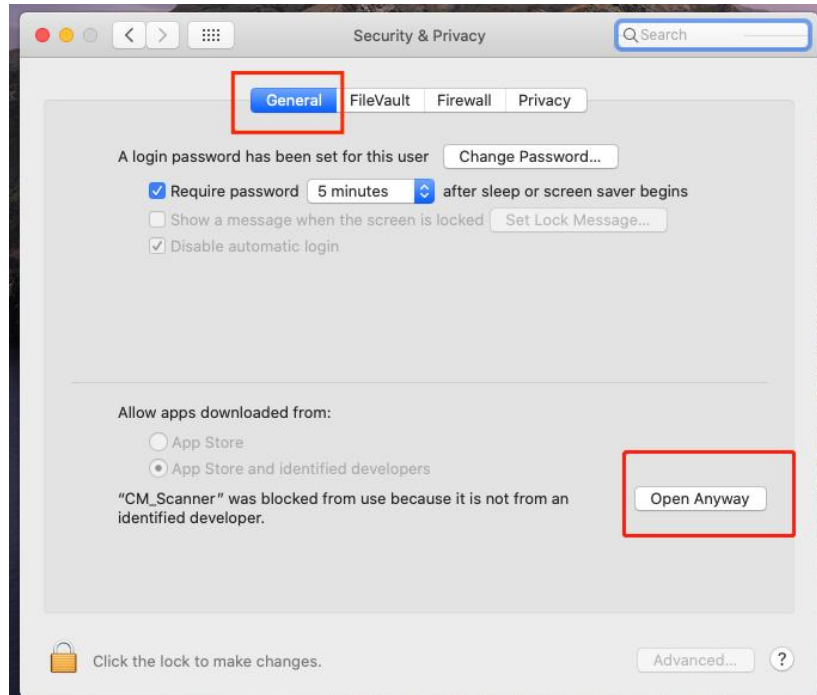

Pic.0-3

If the following prompts continue to pop up, click the "Open" and “OK”(Pic.0-4).

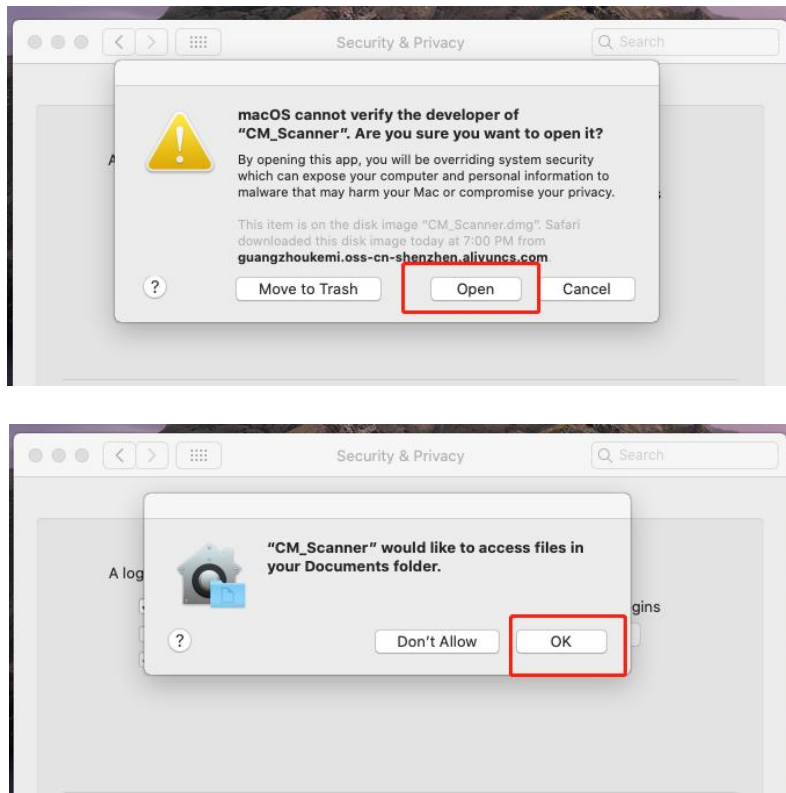

Pic.0-4

After the above steps are completed, open the software again.

Interface description

1.Open software



Double click “CM_Scanner” icon and start the software. Operation interface of software as follow (Pic.1-1)

2.The basic interface of software is mainly divided into five areas(Pic.1-1).

- 2.1 ① image preview area
- 2.2 ② Camera view
- 2.3 ③ Auxiliary function
- 2.4 ④ Tools for preview area
- 2.5 ⑤ Function area

Following contents are function description:

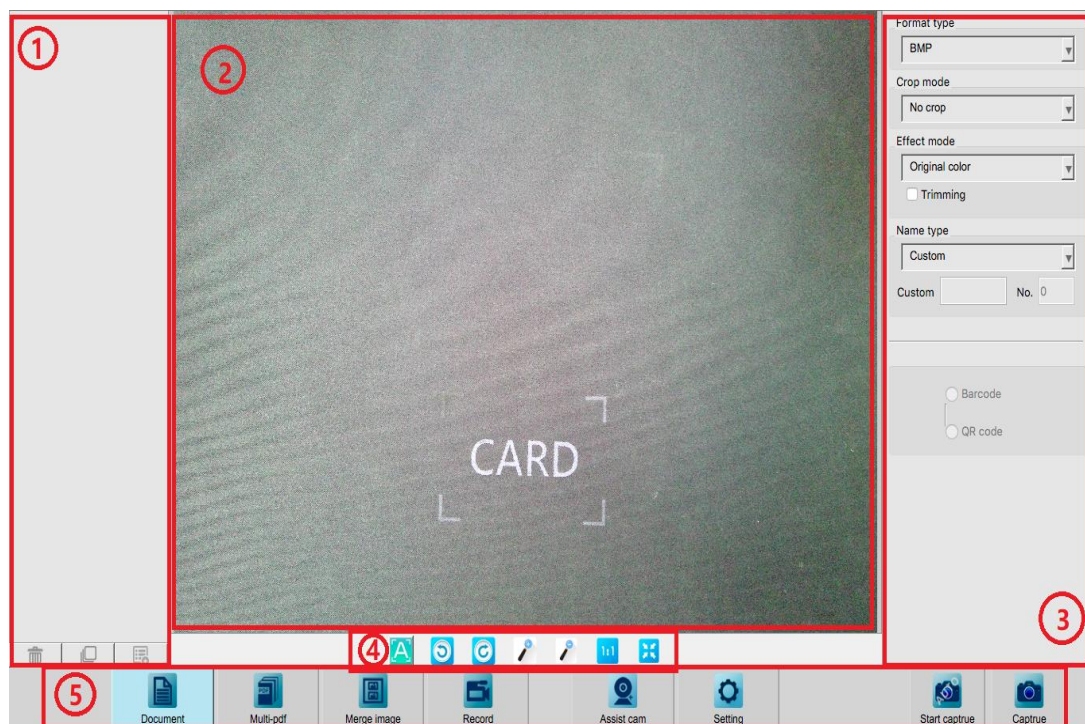

Pic.1-1

Function description

1. Image preview

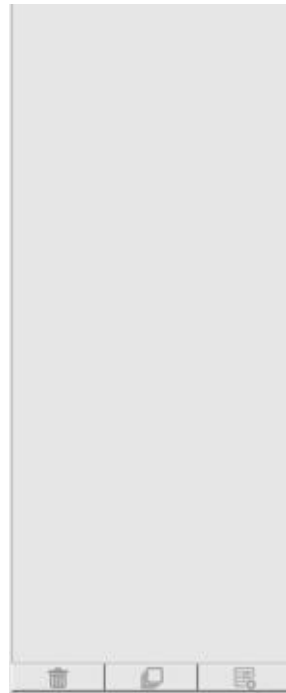

Pic.2-1



Delete: Deletes the selected file in the preview area.



Select all: Select all files in the preview area



Add file: Add files from different paths and show in the image preview area

2. Camera view

It displays the view from camera of document scanner. Shown in (Pic.2-2)



Pic.2-2

3. Auxiliary function(Pic.3-1)

Format type
BMP

Crop mode
No crop

Effect mode
Original color
☐ Trimming

Name type
Custom

Custom No. 0

☐ Barcode
☐ QR code

Pic.3-1

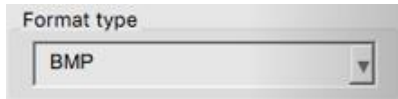

- 3.1** **Format type:** Switch different document formats. The captured photos will be set to corresponding format according to selection.(BMP, PNG, TIF, PDF)

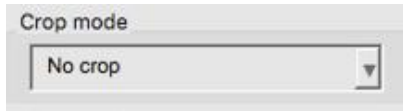

- 3.2** **Crop mode:** Switch different crop mode. When shooting a document, the preview area is cropped according to the mode.(No crop, Automatic crop, Manual crop, Multi-graph crop)



- 3.3** **Effect mode:** Switch different image effect mode. Color processing for captured image according to selected effect mode. (Original color, Gray, Binarization, Document optimization)

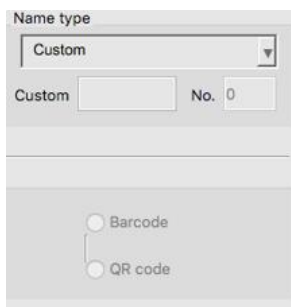







- 3.4** **Name type:** Switch different document naming modes. The captured document will be named according to the settings(No., Date and time, Custom, Name as folder, Barcode number)

4. Tools for preview area(Pic.4-1)



Pic.4-1

- 4.1  **Focus:** Adjust the focus.
- 4.2  **Rotate left:** Rotate the preview area 90 degrees to the left.
- 4.3  **Rotate right:** Rotate the preview area 90 degrees to the right.
- 4.4  **Zoom in:** Zoom in on the preview area
- 4.5  **Zoom out:** Zoom out on the preview area
- 4.6  **1:1:** The image in the preview area is adjusted 1:1
- 4.7  **self-adaption:** Process the preview area image to restore the best display proportion

5. Function area(Pic.5-1)



Pic.5-1

- 5.1  **Document:** Open the default document function.(function description as above 3.Auxiliary function)

- 5.2  **Multi-pdf:** Click and open the multiple PDF. function area(Pic.5-2). Export all photos collection to a PDF file.



Pic.5-2



5.3 **Marge image:** Click and open Image merging function area(Pic.5-3). Select different page number and page order to combine multiple pictures into one image.

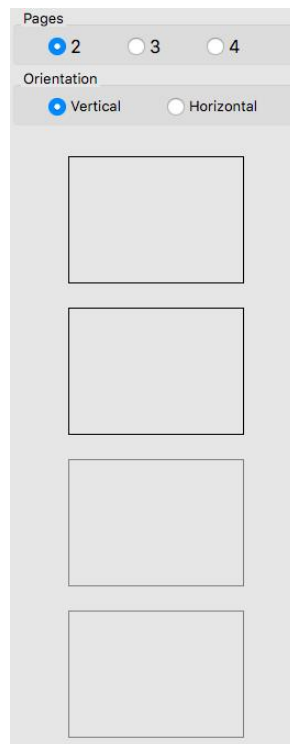

Pic.5-3

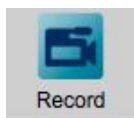

5.4 **Recording:** Click and open recording area(Pic.5-4). Video recording can be performed according to different naming and output format. Click “Start” to start recording and click “Stop” to end the recording. Video files will be displayed on image preview area when it stop recording.

Pic.5-4

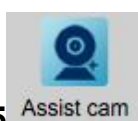

5.5 **Assist cam(Only for dual camera scanner):** Click and open assist camera function area(Pic.5-5).

Merging position: The assist cam window could be placed any position according to settings(Free, Upper left, Upper right, Middle, Bottom left, Bottom right).

Camera image merging: Both the main and secondary cameras view will be displayed on captured image.

Size: The window size of secondary camera.

Open/Close: Open/close secondary camera window.

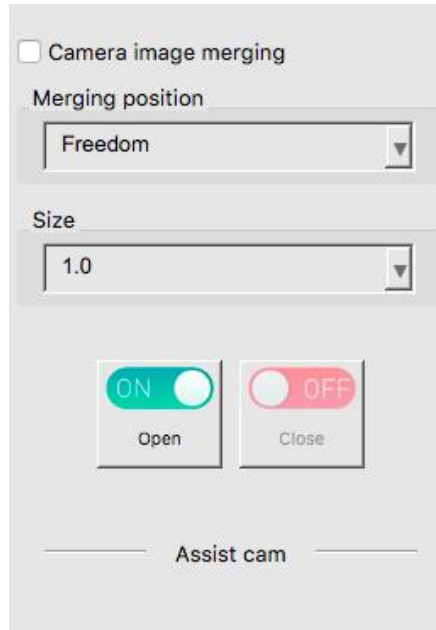

Pic.5-5

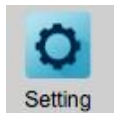

5.6 **Settings:** Click and open Settings area(Pic.5-6).

Device: Select main or secondary camera device(secondary camera option)

Resolution: Select different resolutions to capture according to requirements.

Save path: Save images and documents to different paths on your requirements.

Language: Different language can be selected.

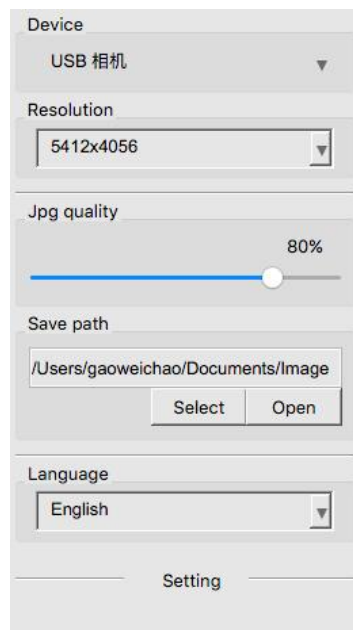

Pic.5-6

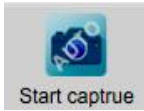

5.7 **Start capture:** If more than 1/3 of the image changes in the camera view area, then it will capture automatically within 3 seconds.



5.8 **Capture:** take a photo.